

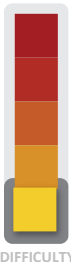

# Installation Instructions

<b>PART NUMBER</b>	<b>162-8011</b>	
<b>PART DESCRIPTION</b>	<b>UPPER PIN WHEEL GUIDE ROLLER ASSEMBLY</b>	
<b>REV DATE</b>	<b>03/12/2012</b>	
<b>MACHINE MODELS</b>		

<b>TOOLS NEEDED</b>	<b>PARTS</b>
11/16" WRENCH 9/16" WRENCH 9/16" SOCKET & RATCHET	162-6011 (1) UPPER PIN WHEEL GUIDE ROLLER 162-2401 (1) SNAP RING 162-9602 (1) BALL BEARING

#### TECHNICAL NOTE

Please thoroughly read the instructions prior to performing the installation of this assembly. To avoid any potential problems, if at any time during the process you have a question, stop and contact our Tech Support department at the numbers listed below.

## STEPS

***WARNING! Always remove power to pinsetter by turning off main circuit breaker and disconnecting high voltage input power cord to electrical box when performing service work.***

1. Remove upper rear elevator guard.
2. Remove elevator cross belt.
3. Release pin wheel belt tension by raising pin wheel brake and removing belt from pulley.
4. Loosen the U-bolt on the guide roller being replaced and rotate the assembly up away from pin wheel.
5. Remove guide roller assembly from guide roller arm and reassemble with new one. *Refer to figure 1.*
6. Rotate the guide roller assembly down until it just makes contact with the pin wheel and tighten U-bolts.



Within USA - 1-800-280-2695  
Outside USA - +1 863-734-0200  
www.kegel.net  
E-Mail: tech@kegel.net

Rev. 9/20



7. Rotate the pin wheel by hand and check for binding in any of the upper or lower guide rollers. ***If binding occurs skip to step 10.***
8. Raise pin wheel brake and place pin wheel belt back on pulley.
9. Reinstall elevator cross belt and upper rear elevator guard.

#### Pin Wheel Guide Roller Adjustment

10. With pin wheel belt tension removed, loosen the U-bolts on both upper guide rollers.
11. Rotate both upper guide roller assemblies away from pin wheel.
12. Check to make sure the pin wheel is properly seated on both lower guide rollers.
13. Rotate both upper guide roller assemblies down until they just make contact with the pin wheel and tighten the U-bolts.
14. Rotate pin wheel by hand to check for binding in any of the guide rollers at the high spots of the pin wheel.
15. If necessary, loosen U-bolts and readjust guide roller assemblies to the high spot of the pin wheel.

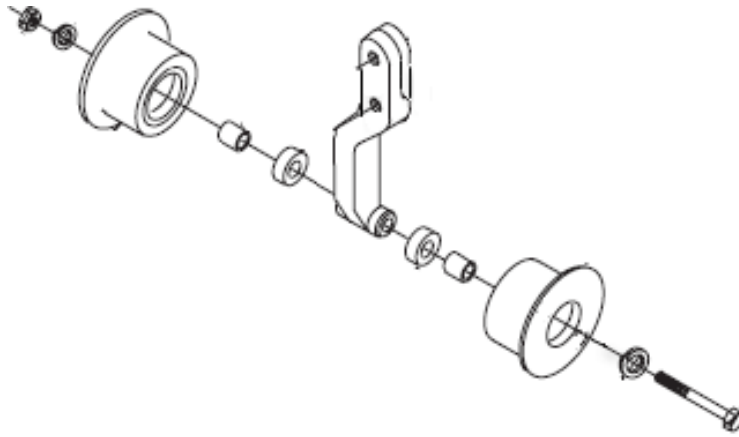

*Figure 1*

#### Kegel Tech Tips

- Inspect the pin wheel belt for wear during this installation process. Replace if necessary.
- Check the pin guide and turnaround pan adjustments after this installation. Adjust if necessary.