



## INSTALLATION INSTRUCTIONS

PART NUMBER	164-8230-2850/2911/1525
PART DESCRIPTION	LID ASSEMBLY
REV DATE	4/11/2020
MACHINE MODELS	FLEX / FLEX WALKER



Basic knowledge of the operation of the lane machine

---

TOOLS NEEDED: None



### TECHNICAL NOTE

Please thoroughly read the instructions prior to performing the installation of this assembly.

To avoid any potential problems, if at any time during the process you have a question, stop and contact our Tech Support department at the numbers listed below.

visit our growing library of videos to see if these instructions are available!  
 [www.youtube.com/user/KegelBowling81](http://www.youtube.com/user/KegelBowling81)

KEGEL TECH SUPPORT:  
Within USA - 1-800-280-2695  
Outside USA - +1 863-734-0200  
via e-mail at [LMC@Kegel.net](mailto:LMC@Kegel.net)  
website [www.kegel.net](http://www.kegel.net)



### Conditioner Compartment Lid Removal

1. Set the machine down in the operating position.
2. Slide the conditioning compartment lid back as shown in the pic below left.
3. Reach your hand under the lid and locate the Lid Pin Ring and pull the spring-loaded pin from the pin guide. Do the same for the 7-side.
4. Tilt the lid assembly up as shown below right. Pull the spring-loaded pin away from the guide and lift lid out of the guides.

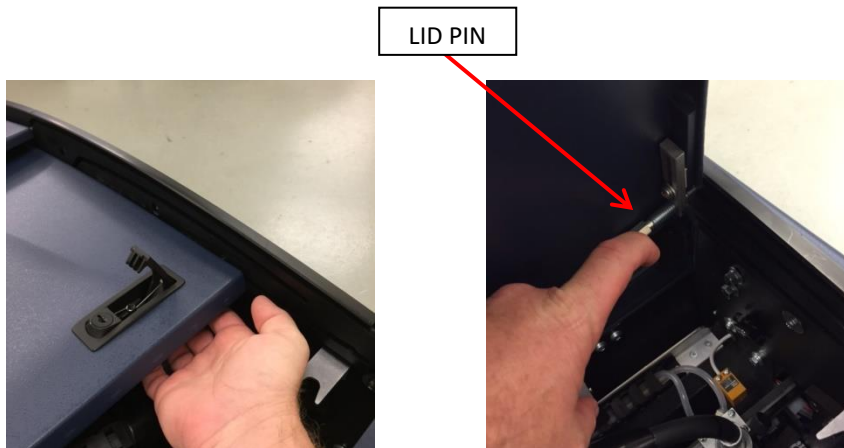

### Cleaning Compartment Lid Removal

1. Set the machine down in the operating position.
2. Stand facing the lane machine from the cleaner compartment side and push the lid until it stops. Reach under each side and pull the pins so the lid will slide the rest of the way back.
3. Lift the cleaner lid assembly up and out of the rear guide opening. Pull the lid towards you and lift the rear portion up and out of the guide openings.

