

# INSTALLATION INSTRUCTIONS



Part Number:	162-6046
Part Name:	<b>Rabbit Ear Repair Kit</b>
Revision Date:	4-20-2012
Written By:	Bill Mongeau
Approved By:	Don Agent

## Packaging Contents:

Qty.	Part Number	Description
1 Ea.	162-6046	Repair Plate
2 Ea.	162-2008	5/16-18 x 3/4" Hex Head Cap Screw
2 Ea.	162-2009	5/16-18 Hex Nut
2 Ea.	153-2015	5/16" Lock Washer

## Tools Required:

1/2" Wrench  
1/2" Socket and Ratchet  
9/16" Wrench  
9/16" Socket and Ratchet  
Drill and 11/32" Drill Bit

Completely read and understand these instructions prior to the installation of this assembly. If you should have any questions please contact Kegel's Pinsetter Part technical support team at one of the contact numbers listed below.

***WARNING! Always remove power to pinsetter by turning off main circuit breaker and disconnecting high voltage input power cord to electrical box when performing service work.***

## Installation Steps:

1. Remove bolt holding rake shock and lift rod to rabbit ear. Retain all hardware for reassembly.
2. Using the new repair plate as a template, align the rake shock mounting hole and the hole for the tension spring roll pin and mark location of new holes. *See figure 1.*
3. Drill new holes in rabbit ear using a 11/32" drill bit. *See figure 1*
4. Secure new plate to rabbit ear. *See figure 2.*
5. Reinstall rake shock, rake lift rod and spring.

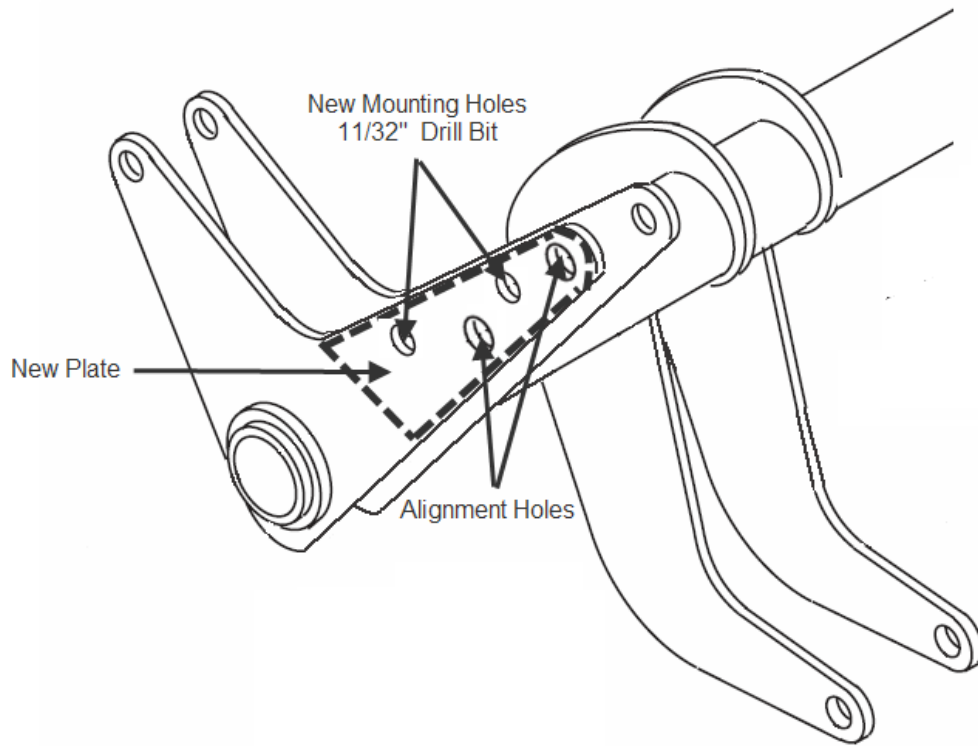

Figure 1



Figure 2