



INSTALLATION INSTRUCTIONS

PART NUMBER	164-8038K
PART DESCRIPTION	SQUEEGEE REPLACEMENT BLADE KIT
REV DATE	6/30/2020
MACHINE MODELS	IKON, FLEX, FXW & 164-8038 Squeegee Assembly



Basic knowledge of the mechanical and electrical



lane machine including

TOOLS NEEDED:

Allen Wrench Cluster

1/2" Wrench

Wire cutters

Loc-tite



TECHNICAL NOTE

Please thoroughly read the instructions prior to performing the installation of this assembly.

To avoid any potential problems, if at any time during the process you have a question, stop and contact our Tech Support department at the numbers listed below.

Please visit our growing library of videos to see if these instructions are available!



www.youtube.com/user/KegelBowling81

KEGEL TECH SUPPORT:

Within USA - 1-800-280-2695

Outside USA - +1 863-734-0200

via e-mail at LMC@Kegel.net

website www.kegel.net



Changing of the Squeegee Blades

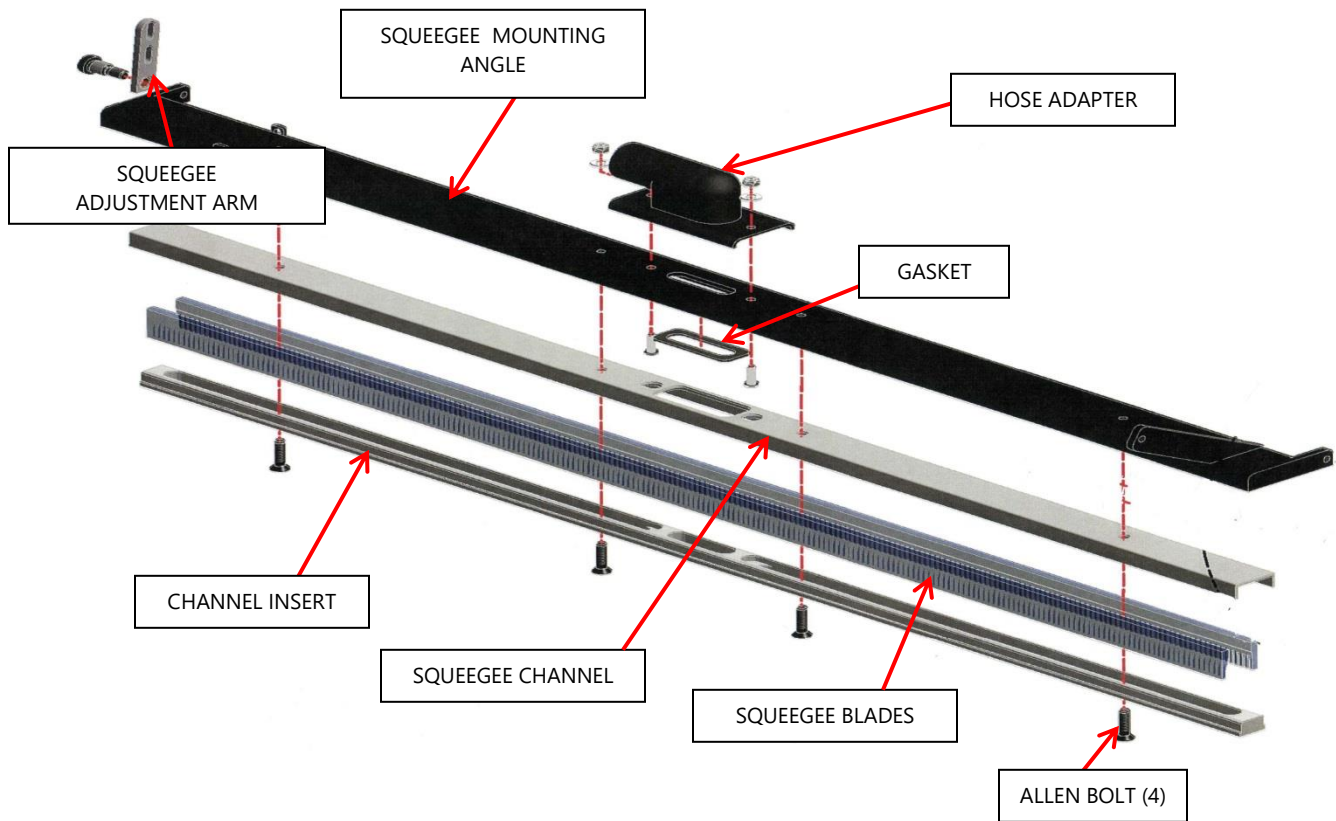

1. Remove the four (4) allen bolts and locknuts from the underside of the assembly, or the (4) Hex-head bolts from the topside of the assembly, depending on which mounting hardware your Squeegee Assy is put together with.
2. Remove the squeegee assembly and place on a workbench.

3. Remove the channel inert from the squeegee channel and remove the old squeegee blades and dispose of. This is a good opportunity to clean the entire assembly.
4. Take the new squeegee blades and lay them evenly from side to side into the center channel with the ribbed side facing out.
5. With the blades resting inside of the channel, take the Channel Insert and press firmly into middle pinching the blades into place.
6. Place the new gasket from the kit into the back side of the assembly and fasten the entire assembly to the mounting angle.



Reinstalling Squeegee assembly

1. Place the assembly into the Squeegee Mounting Angle, and with 4 supplied bolts thread each side into place.
2. Fasten the supplied lock nuts, onto the back side of the bolts.

Squeegee Blade adjustment

3. With the squeegee in the down position, take a straight edge and rest one end on the squeegee blade and rest the opposite end on the rear drive wheels. The gap between the straight edge and the drive wheels should be between $3/16'' - 1/4''$.
4. If an adjustment is needed, loosen the bolts (two on each side) that hold the squeegee adjustment arm in place. Move the adjustment bracket up or down until the correct squeegee height is achieved. This should be done for both the left and the right side.

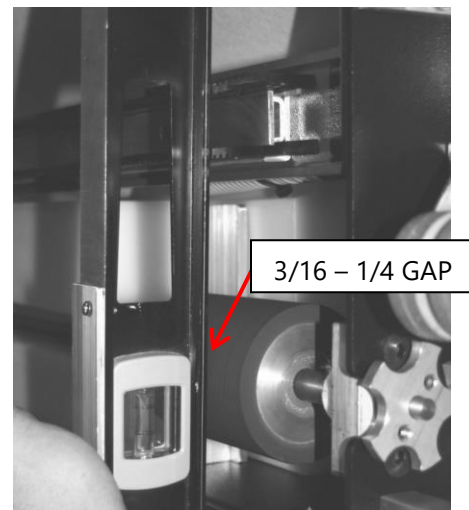

The **tilt** or **pitch** of the squeegee may also need adjustment to ensure that both blades are contacting the lane squarely. If a pitch adjustment is necessary, follow the steps below to make the adjustment. Make sure the squeegee motor does not bind up when making an adjustment. If the link is too short the motor cannot rotate 360° .

1. Locate the squeegee motor on the right-side plate of the machine. Inside the machine, locate the cam that is mounted to the shaft of the Squeegee Motor.

Mounted to the cam is a rod with a rod end. This rod lifts and lowers the squeegee (see diagram below).

2. Loosen the jam nut between the rod end and the rod.
3. Remove the bolt that connects the rod end to the cam.
4. Rotate the rod end as needed to increase or decrease the pitch. **DO NOT** make the linkage too short.
5. Re-install and tighten the bolt to connect the rod end to the cam.
6. Re-check the gap between the straight edge and the drive wheels.
7. Tighten the rod end to the rod with the jam nut.
8. Check cleaning to ensure adjustment is adequate.