

INSTALLATION INSTRUCTIONS



Part Number:	162-8052
Part Name:	Lower Pin Wheel Guide Roller Assembly
Revision Date:	3-12-2012
Written By:	Bill Mongeau
Approved By:	Don Agent

Packaging Contents:

Qty.	Part Number	Description
1 Ea.	162-6052	Lower Pin Wheel Guide Roller
2 Ea.	162-2404	Snap Ring
2 Ea.	162-9601	Ball Bearing
1 Ea.		Installation Instructions

Tools Required:

7/16" Wrench (2)	1-1/8" Deep Well Socket & Ratchet
½" Wrench (2)	11/16" Wrench
9/16" Wrench (2)	

Completely read and understand these instructions prior to the installation of this assembly. If you should have any questions please contact Kegel's Pinsetter Part technical support team at one of the contact numbers listed below.

WARNING! Always remove power to pinsetter by turning off main circuit breaker and disconnecting high voltage input power cord to electrical box when performing service work.

Steps

1. Remove upper rear elevator guard.
2. Remove elevator cross belt.
3. Release pin wheel belt tension by raising pin wheel brake and removing belt from pulley.
4. Loosen the two U-bolts on both upper pin wheel guide rollers and rotate the assemblies up away from pin wheel.
5. Raise and support the pin wheel above the lower guide rollers. **** Both lower pin wheel guide rollers should spin freely at this time.***
6. Remove all hardware mounting lower elevator guard and remove guard. *See figure 1*

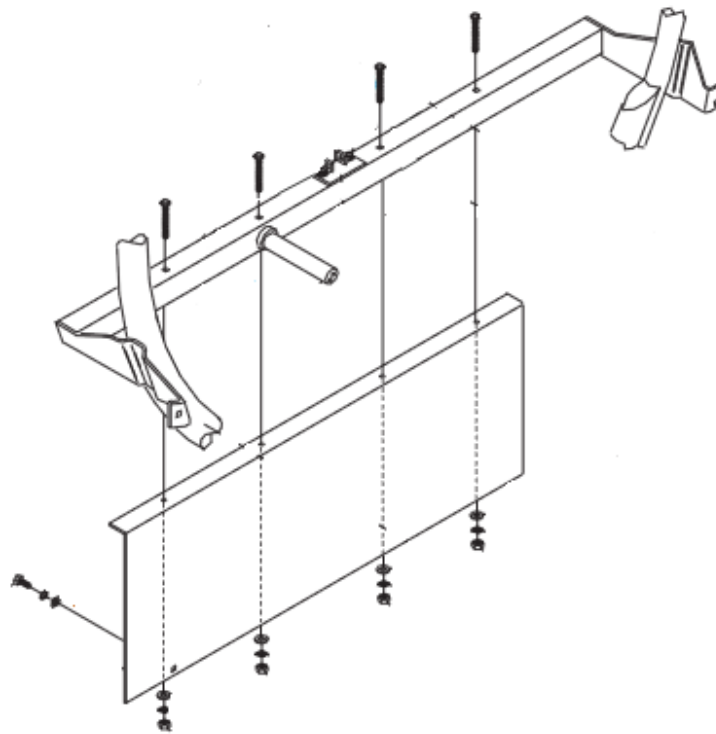

Figure 1

7. Using a 1-1/8" deep well socket remove lower pin wheel guide roller being replaced.
8. Remove old guide roller assembly from guide roller shaft and replace with new assembly.
9. Install new guide roller assembly on pinsetter. *See figure 2 *Different serial number pinsetters may have different hardware. Make note of your hardware configuration upon disassembly.*

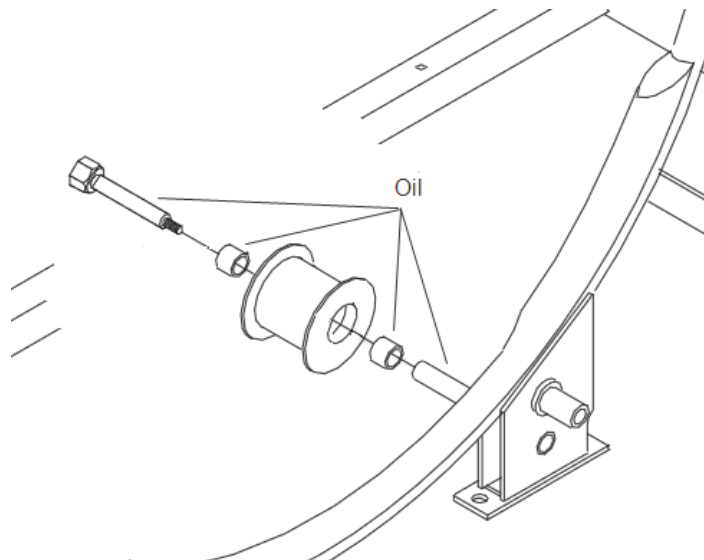

Figure 2

10. Secure lower elevator guard and perform pin wheel guide roller adjustment.

Pin Wheel Guide Roller Adjustment

11. With pin wheel belt tension removed and U-bolts on both upper guide rollers loose, rotate both upper guide roller assemblies down until they just make contact with the pin wheel and tighten the U-bolts.
12. Rotate pin wheel by hand to check for binding in the any of the guide rollers at the high spots of the pin wheel.
13. If necessary, loosen U-bolts and readjust guide roller assemblies to the high spot of the pin wheel.

Kegel Tech Tips

- ✔ Remove, clean, lube bearings and inspect the other lower pin wheel guide roller for wear at this time.
- ✔ Inspect the pin wheel belt for wear during this installation process. Replace if necessary.
- ✔ Clean, inspect and apply a thin film of oil to the guide roller hardware. See figure 1.
- ✔ Check the pin guide and turnaround pan adjustments after this installation. Adjust if necessary.