



INSTALLATION INSTRUCTIONS

PART NUMBER	154-8805 & 154-8805E
PART DESCRIPTION	VACUUM MOTOR CLEANING PROCEDURE
REV DATE	5/03/2003
MACHINE MODELS	ALL MACHINES



Basic knowledge of the lane machine including mechanical and electrical

TOOLS NEEDED:

½" Deep Socket
Vise Grips or Pliers
Rubber Mallet

1/8" T-Allen Wrench
Flathead Screwdriver
Permanent Marker

Hammer
5/16" Socket
7/16" Wrench



TECHNICAL NOTE

Please thoroughly read the instructions prior to performing the installation of this assembly.

To avoid any potential problems, if at any time during the process you have a question, stop and contact our Tech Support department at the numbers listed below.

Please visit our growing library of videos to see if these instructions are available!



www.youtube.com/user/KegelBowling81



- Place orders with Distributor
- Maintenance reminders on phone
- Software updates
- How to videos

Take full control of your lane machine at My.kegel.net

Kegel's Lane Maintenance Central:
Within USA - 1-800-280-2695
Outside USA - +1 863-734-0200
via e-mail at LMC@Kegel.net
website www.kegel.net



1. Take the lid off of the machine. Locate the mounting blocks on each side of the machine that holds the lid on and remove the mounting block off the ten-pin side.
2. The vacuum motor is held in with railing or fasteners. If held in with railing, the vacuum will slide right out. If the vacuum is held with fasteners, a flat head screw driver and a 7/16" wrench will be needed to take vacuum off. After taking the vacuum motor out of the machine, the vacuum will need to be taken off of its aluminum housing using a 5/16" nut driver.
3. The first step in taking apart the vacuum motor is making some reference marks on the vacuum motor so it can be reassembled correctly. The first marks that need to be made are on the inside of the vacuum inlet. When looking in the vacuum inlet there is nut, washer, and a silver disk. Draw or scratch a line across the nut, washer, silver disk and the end of the shaft.

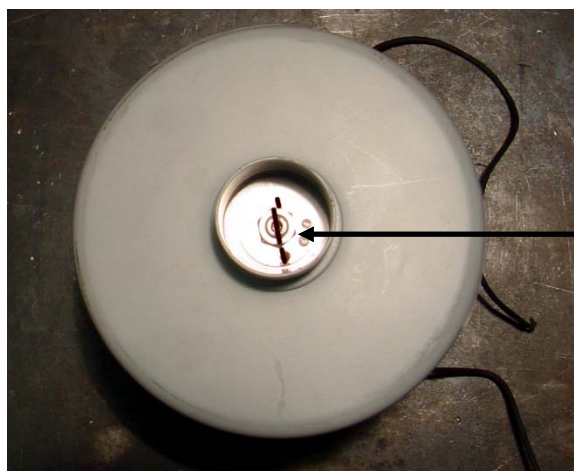

STEP 3



- Place orders with Distributor
- Maintenance reminders on phone
- Software updates
- How to videos

Take full control of your
lane machine at
My.kegel.net

Kegel's Lane Maintenance Central:
Within USA - 1-800-280-2695
Outside USA - +1 863-734-0200
via e-mail at LMC@Kegel.net
website www.kegel.net



Rev. 3.14

4. After marking everything inside the inlet a reference mark will need to be put on the canister where it meets up with the plastic housing.



5. Now that the initial reference marks have been made put the 1/2" socket on and insert the 1/8" T-Allen through the socket into the shaft end. Hold the 1/8" T-Allen, and turn the socket to break the nut loose.



6. Now that everything is loosened the Gray canister will need to be taken off. Don't forget the reference marks. The canister is crimped onto the plastic housing in (3) areas but there is (6) locations possible. Take a screwdriver and pry the crimp out carefully in these sections so that the canister is no longer biting into the plastic housing.



- Place orders with Distributor
- Maintenance reminders on phone
- Software updates
- How to videos

Take full control of your
lane machine at
My.kegel.net

Kegel's Lane Maintenance Central:
Within USA - 1-800-280-2695
Outside USA - +1 863-734-0200
via e-mail at LMC@Kegel.net
website www.kegel.net



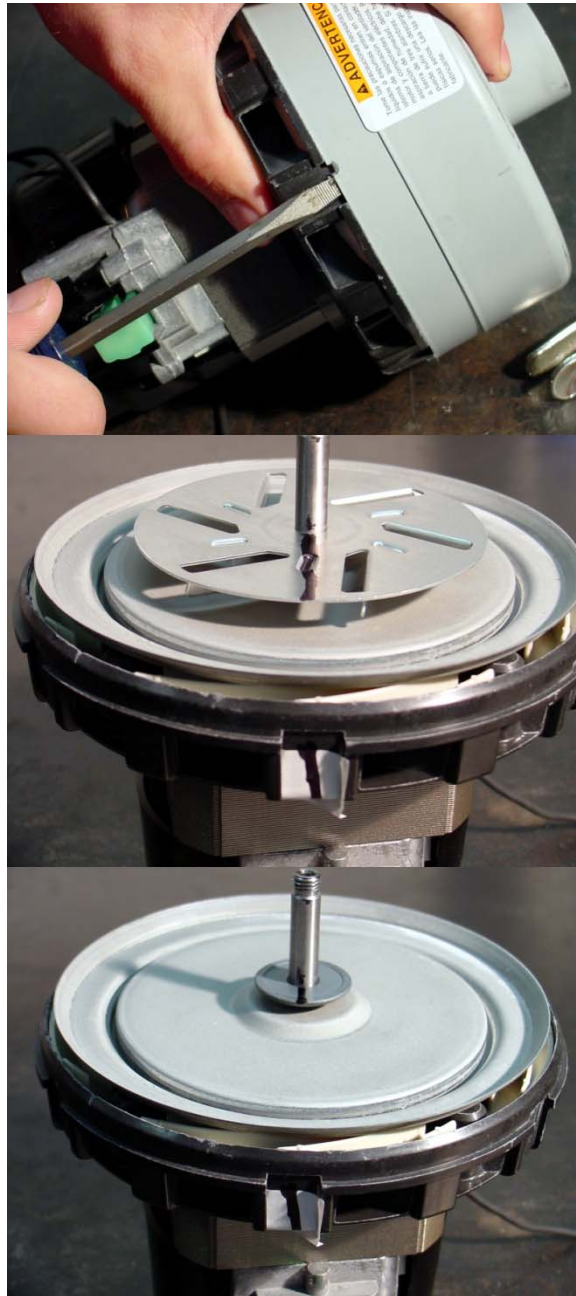

7. After bending the crimps out, use the screwdriver to tap the canister off the plastic housing, alternating sides when doing this. Use caution when removing the canister, make sure the inner fan blades do not turn.



- Place orders with Distributor
- Maintenance reminders on phone
- Software updates
- How to videos

Take full control of your
lane machine at
My.kegel.net

Kegel's Lane Maintenance Central:
Within USA - 1-800-280-2695
Outside USA - +1 863-734-0200
via e-mail at LMC@Kegel.net
website www.kegel.net



- Now that the canister is off, locate the initial reference mark made on the motor shaft. Mark the top of metal fan blade and the hub/spacer so that they line up with the reference mark (use a permanent marker or something metal to scratch the top of the surface). Now slide these two pieces off and there will be another smaller fan blade underneath these two pieces. This blade will need to be marked on top and taken off also. The phenolic spacer underneath these blades will need to be marked on top and taken off as well.

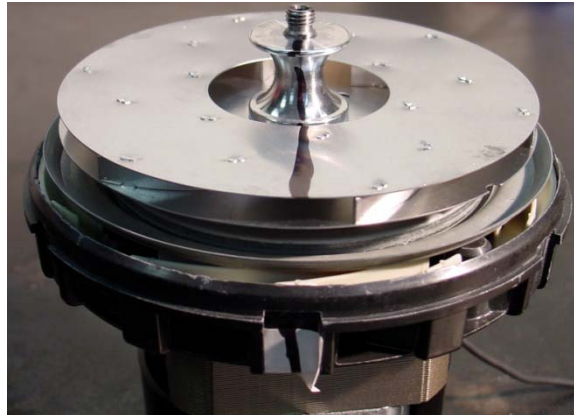

- After the vacuum has been disassembled clean the canister and blades. The blades should be scrubbed and the canister should soak in hot water. Hot water should take all the sludge off of the blades and out of the canister. After cleaning the canister and blades, clean all the crevices and exhaust ports of the main vacuum motor.
- After everything is clean and dry reassemble the motor.
- Take the black phenolic spacer and put it back on the shaft with ridged side facing down. Now take the small fan blade and slide it on the shaft, then put the bigger fan on and line up all reference marks. Now slide the hub on over both of the fan blades lining it up the same as everything else.
- Now carefully tap the canister on and line up the fan blade inside the canister so that it is inline with all the other reference marks and be certain that the canister is seated on the plastic housing. Put the washer and nut back on and retighten with the T-Allen and socket. If everything is back on and lined up correctly take a screwdriver and re-crimp the canister back onto the plastic housing.
- Reassemble the motor back on the aluminum housing and reinstall in the machine. Go to test output and run the vacuum. **WARNING**, never run the vacuum without the plastic guard over the metal fan blades.



- Place orders with Distributor
- Maintenance reminders on phone
- Software updates
- How to videos

Take full control of your
lane machine at
My.kegel.net

Kegel's Lane Maintenance Central:
Within USA - 1-800-280-2695
Outside USA - +1 863-734-0200
via e-mail at LMC@Kegel.net
website www.kegel.net

